



Features:

- M8*1 mm , Brass,nickel-plated housing;
- 1mm , flush mountable;
- DC 3-wire , switching output;
- Cable



Dimensioned drawing

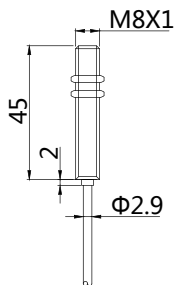

Model No.

Sensing range	Sn:1 mm
NPN N. O	CB-M801N-C11P2
NPN N. C	CB-M801N-C21P2
PNP N. O	CB-M801P-C11P2
PNP N. C	CB-M801P-C21P2

Mounting

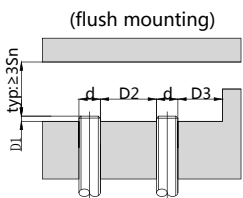

Sn	D1	D2	D3
M801	≥0	≥8	≥8

⚠ Tightening torque of the fastening screws: <10Nm!

Correction Factor	
Nav-ferrous metal	Factor
Water	1
Alcohol	0.7
Ceramic	0.6
Glass	0.5
Oil	0.3

Technical data

Electrical data	Operating voltage	10-30V DC
	Switching frequency	100Hz
	Voltage drop	≤2.0V
	Leakge current	<0.01mA
	Load current	100mA
	No load current	≤10mA(24V)
	Hysteresis	<15%(Sr)
	Repeatability	<5.0%(Sr)
	Temperature drift	<10%(Sr)
	Short circuit protection	Yes
Overload protection	Yes	
Polarity reversal protection	Yes	
Environment	Ambient temperature	-25...70°C
	Ingress protection	IP67
Mechanical data	Housing material	Brass,nickel-plated
	Face material	POM
Electrical connection	Connectors	PVC cable/2m ; 3*0.18mm ²
Accessories	Accessories	NO
		(to be ordered separately)

Wiring

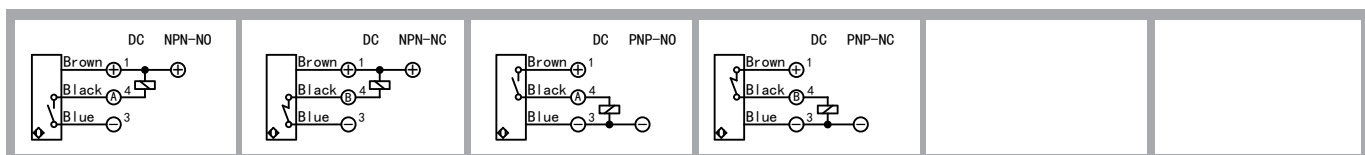



Features:

- M8*1 mm , Brass,nickel-plated housing;
- 2mm , non-flush mountable;
- DC 3-wire , switching output;
- Cable



Dimensioned drawing

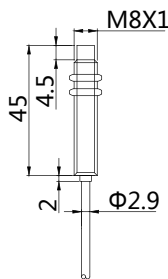

Model No.

Sensing range	Sn: 2 mm
NPN N. O	CN-M802N-C11P2
NPN N. C	CN-M802N-C21P2
PNP N. O	CN-M802P-C11P2
PNP N. C	CN-M802P-C21P2

Mounting

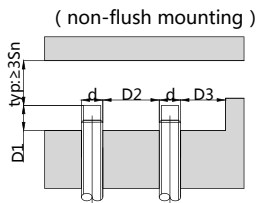

Sn	D1	D2	D3
M802	≥6	≥16	≥8

⚠ Tightening torque of the fastening screws: <10Nm!

Correction Factor	
Nav-ferrous metal	Factor
Water	1
Alcohol	0.7
Ceramic	0.6
Glass	0.5
Oil	0.3

Technical data

Electrical data	Operating voltage	10-30V DC
	Switching frequency	100Hz
	Voltage drop	≤2.0V
	Leakge current	<0.01mA
	Load current	100mA
	No load current	≤10mA(24V)
	Hysteresis	<15%(Sr)
	Repeatability	<5.0%(Sr)
	Temperature drift	<10%(Sr)
	Short circuit protection	Yes
	Overload protection	Yes
Polarity reversal protection	Yes	
Environment	Ambient temperature	-25...70°C
	Ingress protection	IP67
Mechanical data	Housing material	Brass,nickel-plated
	Face material	POM
Electrical connection	Connectors	PVC cable/2m ; 3*0.18mm²
Accessories	Accessories	NO
		(to be ordered separately)

Wiring

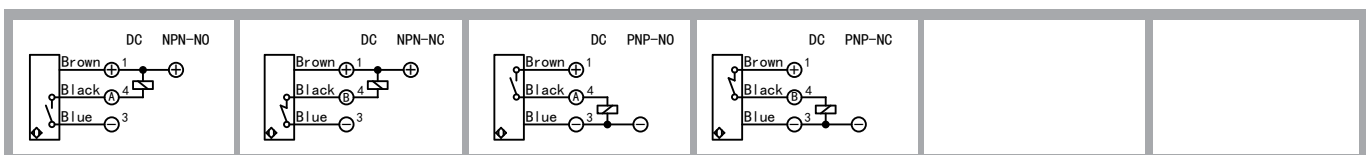

Features:

- M8*1 mm , Brass,nickel-plated housing;
- 1mm , flush mountable;
- DC 3-wire , switching output;
- Connector versions



Dimensioned drawing

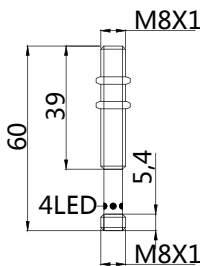

Model No.

Sensing range	Sn: 1 mm
NPN N. O	CB-M801N-C11S8
NPN N. C	CB-M801N-C21S8
PNP N. O	CB-M801P-C11S8
PNP N. C	CB-M801P-C21S8

Mounting

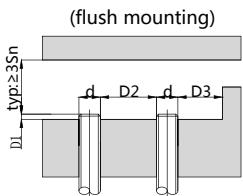

Sn	D1	D2	D3
M801	≥0	≥8	≥8

⚠ Tightening torque of the fastening screws: <10Nm!

Correction Factor	
Nav-ferrous metal	Factor
Water	1
Alcohol	0.7
Ceramic	0.6
Glass	0.5
Oil	0.3

Technical data

Electrical data	Operating voltage	10-30V DC
	Switching frequency	100Hz
	Voltage drop	≤2.0V
	Leakage current	<0.01mA
	Load current	100mA
	No load current	≤10mA(24V)
	Hysteresis	<15%(Sr)
	Repeatability	<5.0%(Sr)
	Temperature drift	<10%(Sr)
	Short circuit protection	Yes
	Overload protection	Yes
Polarity reversal protection	Yes	
Environment	Ambient temperature	-25...70°C
	Ingress protection	IP67
Mechanical data	Housing material	Brass,nickel-plated
	Face material	POM
Electrical connection	Connectors	M8 connector
Accessories	Accessories	B8-3GV2/B8-3WV2
		(to be ordered separately)

Wiring

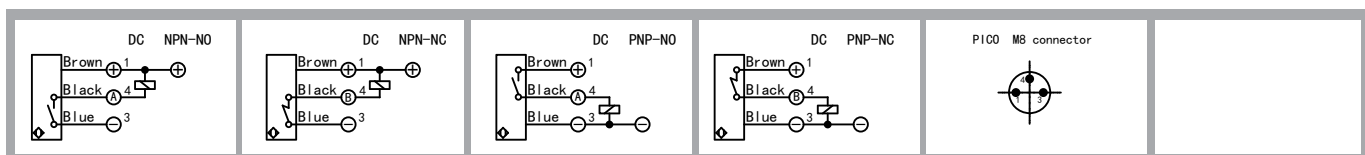



Features:

- M8*1 mm , Brass,nickel-plated housing;
- 2mm , non-flush mountable;
- DC 3-wire , switching output;
- Connector versions



Dimensioned drawing

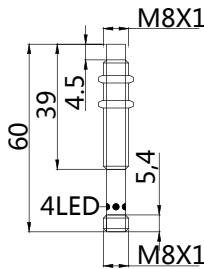

Model No.

Sensing range	Sn: 2 mm
NPN N. O	CN-M802N-C11S8
NPN N. C	CN-M802N-C21S8
PNP N. O	CN-M802P-C11S8
PNP N. C	CN-M802P-C21S8

Mounting

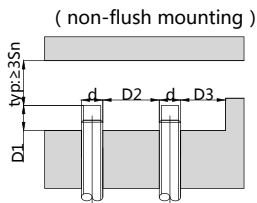

Sn	D1	D2	D3
M802	≥6	≥16	≥8

⚠ Tightening torque of the fastening screws: <10Nm!

Correction Factor	
Nav-ferrous metal	Factor
Water	1
Alcohol	0.7
Ceramic	0.6
Glass	0.5
Oil	0.3

Technical data

Electrical data	Operating voltage	10-30V DC
	Switching frequency	100Hz
	Voltage drop	≤2.0V
	Leakage current	<0.01mA
	Load current	100mA
	No load current	≤10mA(24V)
	Hysteresis	<15%(Sr)
	Repeatability	<5.0%(Sr)
	Temperature drift	<10%(Sr)
	Short circuit protection	Yes
Overload protection	Yes	
Polarity reversal protection	Yes	
Environment	Ambient temperature	-25...70°C
	Ingress protection	IP67
Mechanical data	Housing material	Brass,nickel-plated
	Face material	POM
Electrical connection	Connectors	M8 connector
Accessories	Accessories	B8-3GV2/B8-3WV2
		(to be ordered separately)

Wiring

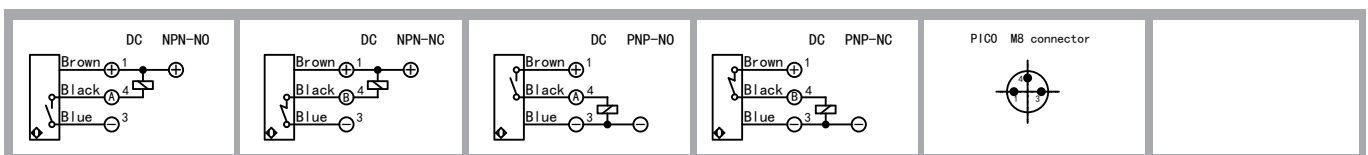

Features:

- M8*1 mm , Brass,nickel-plated housing;
- 1mm , flush mountable;
- DC 3-wire , switching output;
- Connector versions



Dimensioned drawing

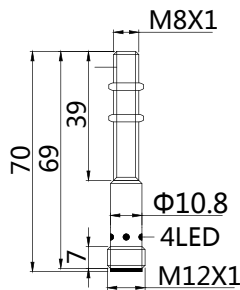

Model No.

Sensing range	Sn: 1 mm
NPN N. O	CB-M801N-C11S12
NPN N. C	CB-M801N-C21S12
PNP N. O	CB-M801P-C11S12
PNP N. C	CB-M801P-C21S12

Mounting

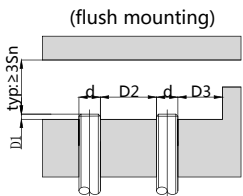

Sn	D1	D2	D3
M801	≥0	≥8	≥8

⚠ Tightening torque of the fastening screws: <10Nm!

Correction Factor	
Nav-ferrous metal	Factor
Water	1
Alcohol	0.7
Ceramic	0.6
Glass	0.5
Oil	0.3

Technical data

Electrical data	Operating voltage	10-30V DC
	Switching frequency	100Hz
	Voltage drop	≤2.0V
	Leakage current	<0.01mA
	Load current	100mA
	No load current	≤10mA(24V)
	Hysteresis	<15%(Sr)
	Repeatability	<5.0%(Sr)
	Temperature drift	<10%(Sr)
	Short circuit protection	Yes
	Overload protection	Yes
	Polarity reversal protection	Yes
Environment	Ambient temperature	-25...70°C
	Ingress protection	IP67
Mechanical data	Housing material	Brass,nickel-plated
	Face material	POM
Electrical connection	Connectors	M12 connector
Accessories	Accessories	B12-4GV2/B12-4WV2
		(to be ordered separately)

Wiring

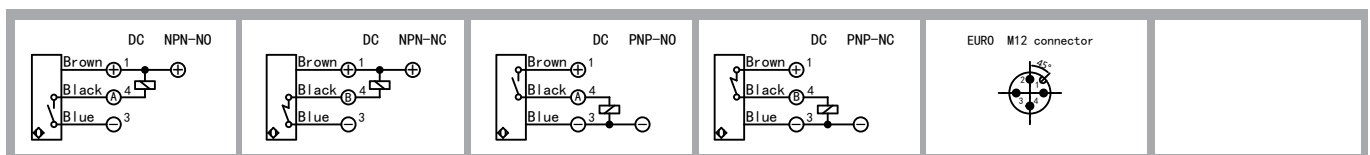

Features:

- M8*1 mm , Brass,nickel-plated housing;
- 2mm , non-flush mountable;
- DC 3-wire , switching output;
- Connector versions



Dimensioned drawing

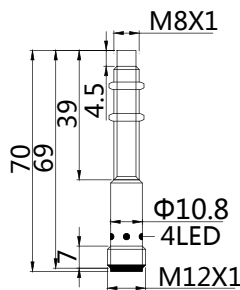

Model No.

Sensing range	Sn: 2 mm
NPN N. O	CN-M802N-C11S12
NPN N. C	CN-M802N-C21S12
PNP N. O	CN-M802P-C11S12
PNP N. C	CN-M802P-C21S12

Mounting

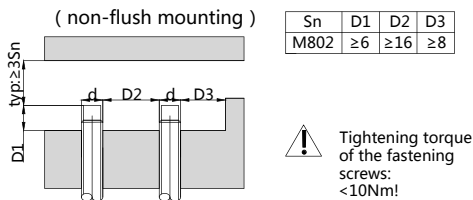

Correction Factor	
Non-ferrous metal	Factor
Water	1
Alcohol	0.7
Ceramic	0.6
Glass	0.5
Oil	0.3

Technical data

Electrical data	Operating voltage	10-30V DC
	Switching frequency	100Hz
	Voltage drop	≤2.0V
	Leakage current	<0.01mA
	Load current	100mA
	No load current	≤10mA(24V)
	Hysteresis	<15%(Sr)
	Repeatability	<5.0%(Sr)
	Temperature drift	<10%(Sr)
	Short circuit protection	Yes
Overload protection	Yes	
Polarity reversal protection	Yes	
Environment	Ambient temperature	-25...70°C
	Ingress protection	IP67
Mechanical data	Housing material	Brass,nickel-plated
	Face material	POM
Electrical connection	Connectors	M12 connector
Accessories	Accessories	B12-4GV2/B12-4WV2
		(to be ordered separately)

Wiring

