



Features:

- M18*1 mm , Plastic/Brass,nickel-plated housing;
- 5mm , flush mountable;
- DC 3-wire , switching output;
- Cable



Dimensioned drawing

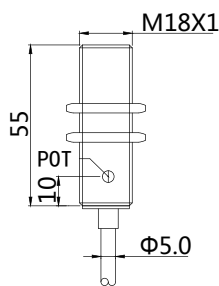

Model No.

Housing material	Brass, nickel-plated	PBT
NPN N. O	CB-M1805N-C11P2	CB-M1805N-P11P2
NPN N. C	CB-M1805N-C21P2	CB-M1805N-P21P2
PNP N. O	CB-M1805P-C11P2	CB-M1805P-P11P2
PNP N. C	CB-M1805P-C21P2	CB-M1805P-P21P2

Mounting

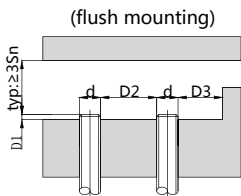

Sn	D1	D2	D3
M1805	≥0	≥18	≥18

⚠ Tightening torque of the fastening screws: <20Nm!

⚠ Tightening torque of the fastening screws: <1.5Nm!(PBT)

Correction Factor	
Nav-ferrous metal	Factor
Water	1
Alcohol	0.7
Ceramic	0.6
Glass	0.5
Oil	0.3

Technical data

Electrical data	Operating voltage	10-30V DC
	Switching frequency	100Hz
	Voltage drop	≤2.0V
	Leakge current	<0.01mA
	Load current	200mA
	No load current	≤10mA(24V)
	Hysteresis	<15%(Sr)
	Repeatability	<5.0%(Sr)
	Temperature drift	<10%(Sr)
	Short circuit protection	Yes
Overload protection	Yes	
Polarity reversal protection	Yes	
Environment	Ambient temperature	-25...70°C
	Ingress protection	IP67
Mechanical data	Housing material	Brass,nickel-plated/PBT
	Face material	PBT
Electrical connection	Connectors	PVC cable/2m ; 3*0.35mm²
Accessories	Accessories	NO
		(to be ordered separately)

Wiring

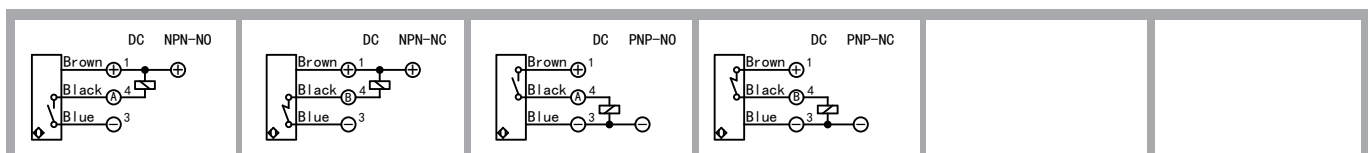



Features:

- M18*1 mm , Plastic/Brass,nickel-plated housing;
- 8mm , non-flush mountable;
- DC 3-wire , switching output;
- Cable



Dimensioned drawing

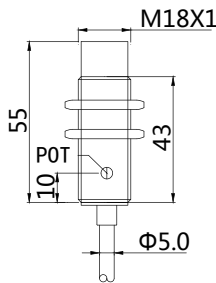

Model No.

Housing material	Brass, nickel-plated	PBT
NPN N. O	CN-M1808N-C11P2	CN-M1808N-P11P2
NPN N. C	CN-M1808N-C21P2	CN-M1808N-P21P2
PNP N. O	CN-M1808P-C11P2	CN-M1808P-P11P2
PNP N. C	CN-M1808P-C21P2	CN-M1808P-P21P2

Mounting

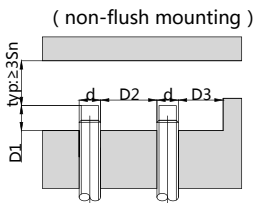

Sn	D1	D2	D3
M1808	≥16	≥36	≥18

⚠ Tightening torque of the fastening screws: <20Nm!

⚠ Tightening torque of the fastening screws: <1.5Nm!(PBT)

Correction Factor	
Nav-ferrous metal	Factor
Water	1
Alcohol	0.7
Ceramic	0.6
Glass	0.5
Oil	0.3

Technical data

Electrical data	Operating voltage	10-30V DC
	Switching frequency	100Hz
	Voltage drop	≤2.0V
	Leakge current	<0.01mA
	Load current	200mA
	No load current	≤10mA(24V)
	Hysteresis	<15%(Sr)
	Repeatability	<5.0%(Sr)
	Temperature drift	<10%(Sr)
	Short circuit protection	Yes
Overload protection	Yes	
Polarity reversal protection	Yes	
Environment	Ambient temperature	-25...70°C
	Ingress protection	IP67
Mechanical data	Housing material	Brass,nickel-plated/PBT
	Face material	PBT
Electrical connection	Connectors	PVC cable/2m ; 3*0.35mm²
Accessories	Accessories	NO
		(to be ordered separately)

Wiring

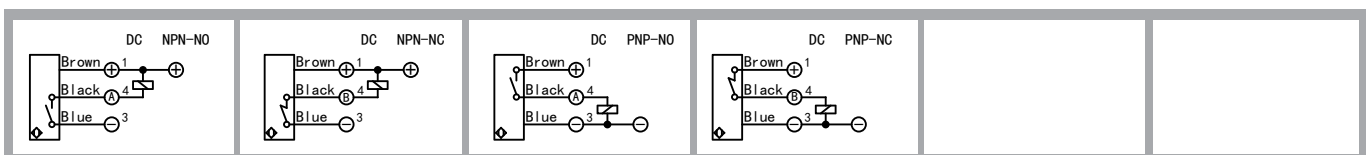



Features:

- M18*1 mm , Plastic/Brass,nickel-plated housing;
- 8mm , flush mountable;
- DC 3-wire , switching output;
- Cable



Dimensioned drawing

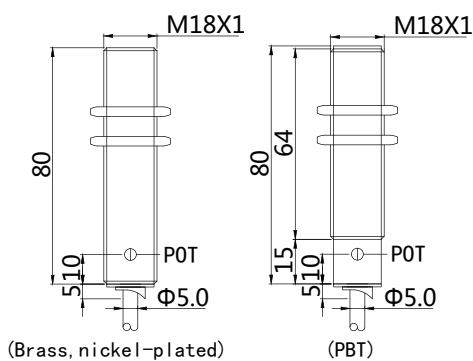

Model No.

Housing material	Brass, nickel-plated	PBT
NPN N. O	CB-M1808N-C11P2	CB-M1808N-P11P2
NPN N. C	CB-M1808N-C21P2	CB-M1808N-P21P2
PNP N. O	CB-M1808P-C11P2	CB-M1808P-P11P2
PNP N. C	CB-M1808P-C21P2	CB-M1808P-P21P2

Mounting

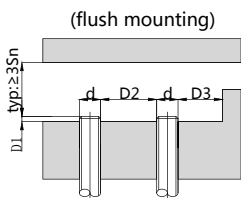

Sn	D1	D2	D3
M1808	≥2.5	≥18	≥18

⚠ Tightening torque of the fastening screws: <20Nm!

⚠ Tightening torque of the fastening screws: <1.5Nm!(PBT)

Correction Factor	
Nav-ferrous metal	Factor
Water	1
Alcohol	0.7
Ceramic	0.6
Glass	0.5
Oil	0.3

Technical data

Electrical data	Operating voltage	10-30V DC
	Switching frequency	100Hz
	Voltage drop	≤2.0V
	Leakge current	<0.01mA
	Load current	200mA
	No load current	≤10mA(24V)
	Hysteresis	<15%(Sr)
	Repeatability	<5.0%(Sr)
	Temperature drift	<10%(Sr)
	Short circuit protection	Yes
Overload protection	Yes	
Polarity reversal protection	Yes	
Environment	Ambient temperature	-25...70°C
	Ingress protection	IP67
Mechanical data	Housing material	Brass,nickel-plated/PBT
	Face material	PBT
Electrical connection	Connectors	PVC cable/2m ; 3*0.35mm ²
Accessories	Accessories	NO
		(to be ordered separately)

Wiring

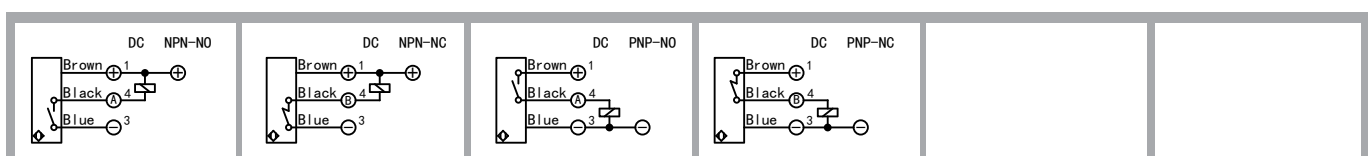



Features:

- M18*1 mm , Plastic/Brass,nickel-plated housing;
- 15mm , non-flush mountable;
- DC 3-wire , switching output;
- Cable



Dimensioned drawing

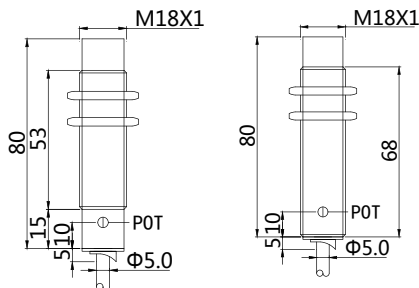

(Brass, nickel-plated)

(PBT)

Mounting

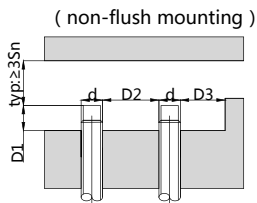

Sn	D1	D2	D3
M1815	≥25	≥36	≥18

⚠ Tightening torque of the fastening screws: <20Nm!

⚠ Tightening torque of the fastening screws: <1.5Nm!(PBT)

Correction Factor	
Non-ferrous metal	Factor
Water	1
Alcohol	0.7
Ceramic	0.6
Glass	0.5
Oil	0.3

Model No.

Housing material	Brass, nickel-plated	PBT
NPN N. O	CN-M1815N-C11P2	CN-M1815N-P11P2
NPN N. C	CN-M1815N-C21P2	CN-M1815N-P21P2
PNP N. O	CN-M1815P-C11P2	CN-M1815P-P11P2
PNP N. C	CN-M1815P-C21P2	CN-M1815P-P21P2

Technical data

Electrical data	Operating voltage	10-30V DC
	Switching frequency	100Hz
	Voltage drop	≤2.0V
	Leakge current	<0.01mA
	Load current	200mA
	No load current	≤10mA(24V)
	Hysteresis	<15%(Sr)
	Repeatability	<5.0%(Sr)
	Temperature drift	<10%(Sr)
	Short circuit protection	Yes
Overload protection	Yes	
Polarity reversal protection	Yes	
Environment	Ambient temperature	-25...70°C
	Ingress protection	IP67
Mechanical data	Housing material	Brass,nickel-plated/PBT
	Face material	PBT
Electrical connection	Connectors	PVC cable/2m ; 3*0.35mm²
Accessories	Accessories	NO
		(to be ordered separately)

Wiring

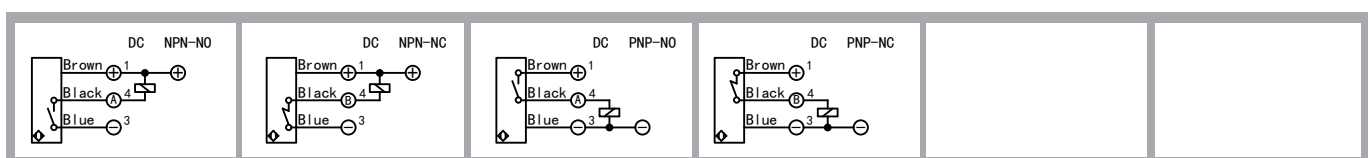



Features:

- M18*1 mm , Plastic/Brass,nickel-plated housing;
- 8mm , flush mountable;
- DC 3-wire , switching output;
- Connector versions



Dimensioned drawing

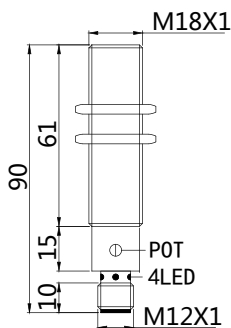

Model No.

Housing material	Brass, nickel-plated	PBT
NPN N. O	CB-M1808N-C11S12	CB-M1808N-P11S12
NPN N. C	CB-M1808N-C21S12	CB-M1808N-P21S12
PNP N. O	CB-M1808P-C11S12	CB-M1808P-P11S12
PNP N. C	CB-M1808P-C21S12	CB-M1808P-P21S12

Mounting

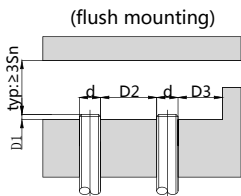

Sn	D1	D2	D3
M1808	≥2.5	≥18	≥18

⚠ Tightening torque of the fastening screws: <20Nm!

⚠ Tightening torque of the fastening screws: <1.5Nm!(PBT)

Correction Factor	
Nav-ferrous metal	Factor
Water	1
Alcohol	0.7
Ceramic	0.6
Glass	0.5
Oil	0.3

Technical data

Electrical data	Operating voltage	10-30V DC
	Switching frequency	100Hz
	Voltage drop	≤2.0V
	Leakge current	<0.01mA
	Load current	200mA
	No load current	≤10mA(24V)
	Hysteresis	<15%(Sr)
	Repeatability	<5.0%(Sr)
	Temperature drift	<10%(Sr)
	Short circuit protection	Yes
Overload protection	Yes	
Polarity reversal protection	Yes	
Environment	Ambient temperature	-25...70°C
	Ingress protection	IP67
Mechanical data	Housing material	Brass,nickel-plated/PBT
	Face material	PBT
Electrical connection	Connectors	M12 connector
Accessories	Accessories	B12-4GV2/B12-4WV2
		(to be ordered separately)

Wiring

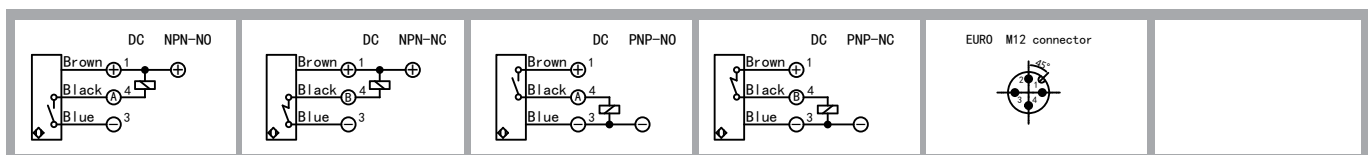



Features:

- M18*1 mm , Plastic/Brass,nickel-plated housing;
- 15mm , non-flush mountable;
- DC 3-wire , switching output;
- Connector versions



Dimensioned drawing

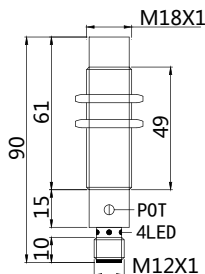

Mounting

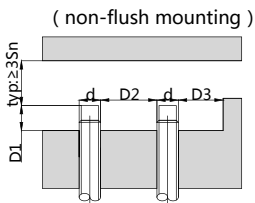

Sn	D1	D2	D3
M1815	≥25	≥36	≥18

⚠ Tightening torque of the fastening screws: <20Nm!

⚠ Tightening torque of the fastening screws: <1.5Nm!(PBT)

Correction Factor	
Nav-ferrous metal	Factor
Water	1
Alcohol	0.7
Ceramic	0.6
Glass	0.5
Oil	0.3

Model No.

Housing material	Brass, nickel-plated	PBT
NPN N. O	CN-M1815N-C11S12	CN-M1815N-P11S12
NPN N. C	CN-M1815N-C21S12	CN-M1815N-P21S12
PNP N. O	CN-M1815P-C11S12	CN-M1815P-P11S12
PNP N. C	CN-M1815P-C21S12	CN-M1815P-P21S12

Technical data

Electrical data	Operating voltage	10-30V DC
	Switching frequency	100Hz
	Voltage drop	≤2.0V
	Leakge current	<0.01mA
	Load current	200mA
	No load current	≤10mA(24V)
	Hysteresis	<15%(Sr)
	Repeatability	<5.0%(Sr)
	Temperature drift	<10%(Sr)
	Short circuit protection	Yes
Overload protection	Yes	
Polarity reversal protection	Yes	
Environment	Ambient temperature	-25...70°C
	Ingress protection	IP67
Mechanical data	Housing material	Brass,nickel-plated/PBT
	Face material	PBT
Electrical connection	Connectors	M12 connector
Accessories	Accessories	B12-4GV2/B12-4WV2
		(to be ordered separately)

Wiring

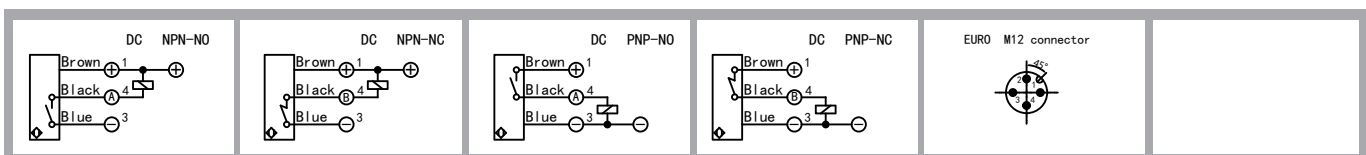



Features:

- M18*1 mm , Plastic/Brass,nickel-plated housing;
- 8mm , flush mountable;
- AC 2-wire , AC/DC 2-wire , switching output;
- Momentary current:5A(20ms)/2.2A(20ms)
- Cable



Dimensioned drawing

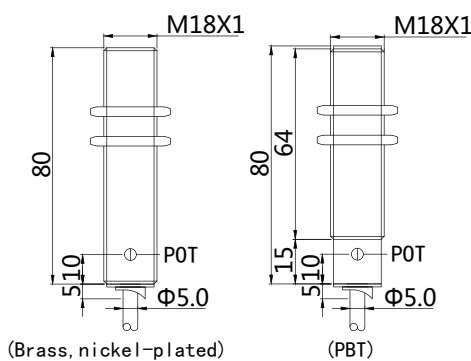

Model No.

Housing material	Brass, nickel-plated	PBT
N. O	CB-M1808A-C14P2	CB-M1808A-P14P2
N. C	CB-M1808A-C24P2	CB-M1808A-P24P2
N. O	CB-M1808U-C15P2	CB-M1808U-P15P2
N. C	CB-M1808U-C25P2	CB-M1808U-P25P2

Mounting

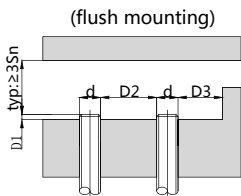

Sn	D1	D2	D3
M1808	≥2.5	≥18	≥18

⚠ Tightening torque of the fastening screws; <20Nm!

⚠ Tightening torque of the fastening screws; <1.5Nm!(PBT)

Correction Factor	
Nav-ferrous metal	Factor
Water	1
Alcohol	0.7
Ceramic	0.6
Glass	0.5
Oil	0.3

Technical data

Electrical data	Operating voltage	20-250V AC,20-250V AC/DC
	Switching frequency	25Hz/25Hz AC,40Hz DC
	Voltage drop	<9VAC(300mA)/<10VAC,<8VDC
	Load current	Max.load:300mA;min.Load:5mA
		Max.load:200mA;min.Load:5mA
	Leakage current	≤2.5mA
	Hysteresis	<15%(Sr)
	Repeatability	<5.0%(Sr)
	Temperature drift	<10%(Sr)
	Polarity reversal protection	Yes
Environment	Ambient temperature	-25...70°C
	Ingress protection	IP67
Mechanical data	Housing material	Brass,nickel-plated/PBT
	Face material	PBT
Electrical connection	Connectors	PVC cable/2m ; 3*0.35mm ²
Accessories	Accessories	NO
		(to be ordered separately)

Wiring

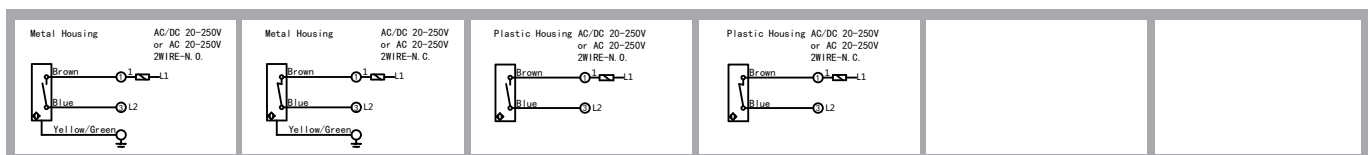



Features:

- M18*1 mm , Plastic/Brass,nickel-plated housing;
- 15mm , non-flush mountable;
- AC 2-wire , AC/DC 2-wire , switching output;
- Momentary current:5A(20ms)/2.2A(20ms)
- Cable



Dimensioned drawing

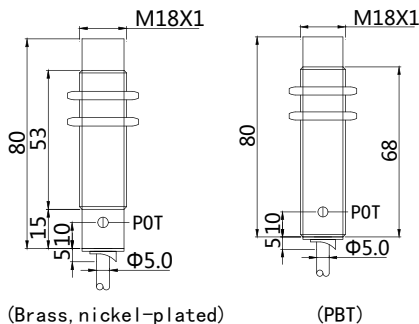

(Brass, nickel-plated)

(PBT)

Mounting

(non-flush mounting)

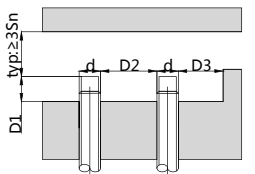

Sn	D1	D2	D3
M1815	≥25	≥36	≥18

⚠ Tightening torque of the fastening screws; <20Nm!

⚠ Tightening torque of the fastening screws; <1.5Nm!(PBT)

Correction Factor	
Non-ferrous metal	Factor
Water	1
Alcohol	0.7
Ceramic	0.6
Glass	0.5
Oil	0.3

Model No.

Housing material	Brass, nickel-plated	PBT
N. O	CN-M1815A-C14P2	CN-M1815A-P14P2
N. C	CN-M1815A-C24P2	CN-M1815A-P24P2
N. O	CN-M1815U-C15P2	CN-M1815U-P15P2
N. C	CN-M1815U-C25P2	CN-M1815U-P25P2

Technical data

Electrical data	Operating voltage	20-250V AC,20-250V AC/DC
	Switching frequency	25Hz/25Hz AC,40Hz DC
	Voltage drop	<9VAC(300mA)/<10VAC,<8VDC
	Load current	Max.load:300mA;min.Load:5mA
	Leakage current	≤2.5mA
	Hysteresis	<15%(Sr)
	Repeatability	<5.0%(Sr)
	Temperature drift	<10%(Sr)
	Polarity reversal protection	Yes
	Environment	Ambient temperature
Ingress protection		IP67
Mechanical data	Housing material	Brass,nickel-plated/PBT
	Face material	PBT
Electrical connection	Connectors	PVC cable/2m ; 3*0.35mm ²
Accessories	Accessories	NO
(to be ordered separately)		

Wiring

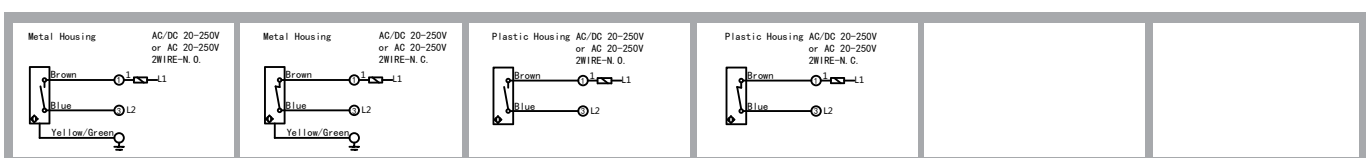



Features:

- M18*1 mm , Plastic/Brass,nickel-plated housing;
- 8mm , flush mountable;
- AC 2-wire , AC/DC 2-wire , switching output;
- Momentary current:5A(20ms)/2.2A(20ms)
- Connector versions



Dimensioned drawing

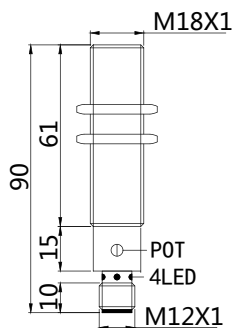

Model No.

Housing material	Brass, nickel-plated	PBT
N. O	CB-M1808A-C14S12	CB-M1808A-P14S12
N. C	CB-M1808A-C24S12	CB-M1808A-P24S12
N. O	CB-M1808U-C15S12	CB-M1808U-P15S12
N. C	CB-M1808U-C25S12	CB-M1808U-P25S12

Mounting

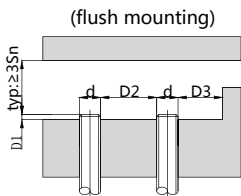

Sn	D1	D2	D3
M1808	≥2.5	≥18	≥18

⚠ Tightening torque of the fastening screws; <20Nm!

⚠ Tightening torque of the fastening screws; <1.5Nm!(PBT)

Correction Factor	
Nav-ferrous metal	Factor
Water	1
Alcohol	0.7
Ceramic	0.6
Glass	0.5
Oil	0.3

Technical data

Electrical data	Operating voltage	20-250V AC,20-250V AC/DC
	Switching frequency	25Hz/25Hz AC,40Hz DC
	Voltage drop	<9VAC(300mA)/<10VAC, <8VDC
	Load current	Max.load:300mA;min.Load:5mA
		Max.load:200mA;min.Load:5mA
	Leakage current	≤2.5mA
	Hysteresis	<15%(Sr)
	Repeatability	<5.0%(Sr)
	Temperature drift	<10%(Sr)
	Polarity reversal protection	Yes
Environment	Ambient temperature	-25...70°C
	Ingress protection	IP67
Mechanical data	Housing material	Brass,nickel-plated/PBT
	Face material	PBT
Electrical connection	Connectors	M12 connector
Accessories	Accessories	B12-4GV2/B12-4WV2
		(to be ordered separately)

Wiring

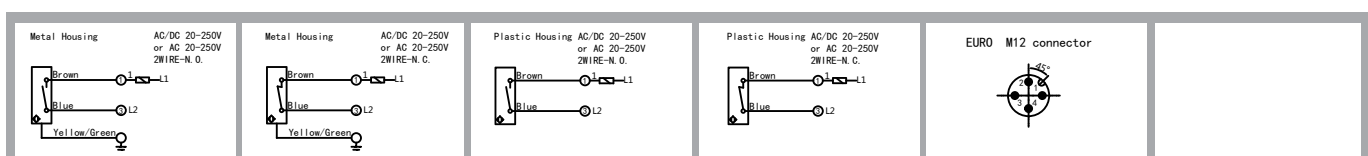



Features:

- M18*1 mm , Plastic/Brass,nickel-plated housing;
- 15mm , non-flush mountable;
- AC 2-wire , AC/DC 2-wire , switching output;
- Momentary current:5A(20ms)/2.2A(20ms)
- Connector versions



Dimensioned drawing

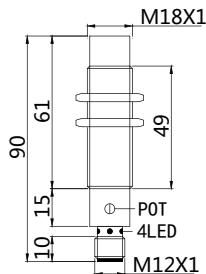

Mounting

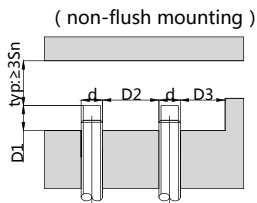

Sn	D1	D2	D3
M1815	≥25	≥36	≥18

⚠ Tightening torque of the fastening screws; <20Nm!

⚠ Tightening torque of the fastening screws; <1.5Nm!(PBT)

Correction Factor	
Nav-ferrous metal	Factor
Water	1
Alcohol	0.7
Ceramic	0.6
Glass	0.5
Oil	0.3

Model No.

Housing material	Brass, nickel-plated	PBT
N. O	CN-M1815A-C14S12	CN-M1815A-P14S12
N. C	CN-M1815A-C24S12	CN-M1815A-P24S12
N. O	CN-M1815U-C15S12	CN-M1815U-P15S12
N. C	CN-M1815U-C25S12	CN-M1815U-P25S12

Technical data

Electrical data	Operating voltage	20-250V AC,20-250V AC/DC
	Switching frequency	25Hz/25Hz AC,40Hz DC
	Voltage drop	<9VAC(300mA)/<10VAC, <8VDC
	Load current	Max.load:300mA;min.Load:5mA
	Leakage current	≤2.5mA
	Hysteresis	<15%(Sr)
Environment	Repeatability	<5.0%(Sr)
	Temperature drift	<10%(Sr)
	Polarity reversal protection	Yes
Mechanical data	Ambient temperature	-25...70°C
	Ingress protection	IP67
Electrical connection	Housing material	Brass,nickel-plated/PBT
	Face material	PBT
Accessories	Connectors	M12 connector
	Accessories	B12-4GV2/B12-4WV2 (to be ordered separately)

Wiring

