

**Features :**

- Plastic housing;
- DC 3-wire,switching output;
- Cable version;
- VDE safety class:III;
- Ingress protection:IP65

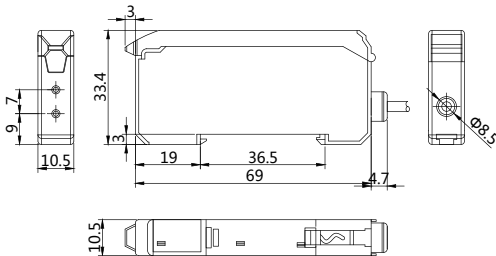

**Dimensioned drawing**



**Model No.**

Light source	Red LED	Green LED
Housing material	PC+ABS	PC+ABS
NPN	FQ10-FRN-P31P2	FQ10-FGN-P31P2
PNP	FQ10-FRP-P31P2	FQ10-FGP-P31P2

**Technical data**

<b>Electrical data</b>	Operating voltage	12-24VDC
	Light type	Red LED/Green LED
	Load current	≤100mA
	No load current	≤40mA
	Voltage drop	<250us
	Switching frequency	1K Hz
	Light immunity	Incandescent Lamp:Max 10000Lux;Fluorescent:Max 20000Lux
	Ambient temperature	-10...55°C
<b>Environment</b>	Ambient humidity	35-85%
	Housing material	PC
	Operating indicator	Output indicator:Red LED
<b>Mechanical data</b>		Digital Display:Red LED
		Square LED display:Green/Red LED
<b>Electrical connection</b>	Connectors	PVC cable/2m;3*0.35mm <sup>2</sup>
<b>Accessories</b>	Accessories	NO
		(to be ordered separately)

**Wiring**

