

Features

- Digital LCD display, easy readout
- Analog output : 1 ~ 5 V or 4 ~ 20 mA
- IP40 enclosure
- Pressure range :
0 ~ 1 kPa, 0 ~ 2 kPa, 0 ~ 5 kPa
-1 ~ 1 kPa, -2 ~ 2 kPa, -5 ~ 5 kPa

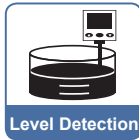
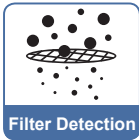

Features Highlight

1 Quick Installation

- Save Installation Time
- Easy Removal

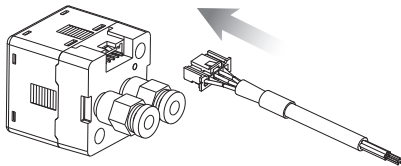

(Removable data cable)

2 Key Lock Function

- Key lock icon is shown on the display when the function is enabled.



3 Save Installation Space

Panel opening for multiple pressure controller

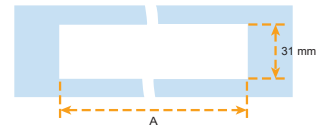

Calculation factor (A) = (34.4 x n) - 3.4
n = number of controller

Actual dimension after installation



4 Liquid Level Detection

- To detect the liquid level by sensing the change of line pressure.

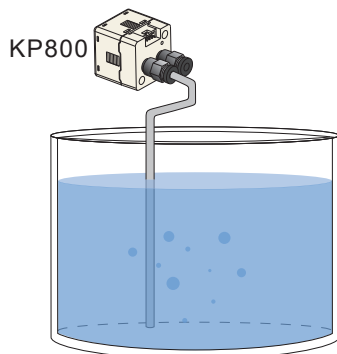

5 Air Flow Detection

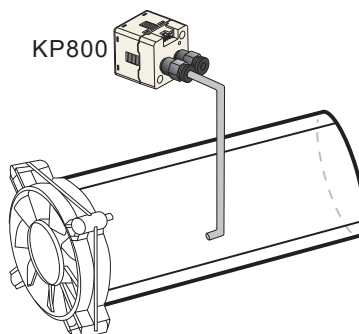

4 Filter Air Monitoring

- To monitor the clogging of filter by detecting the differential pressure.

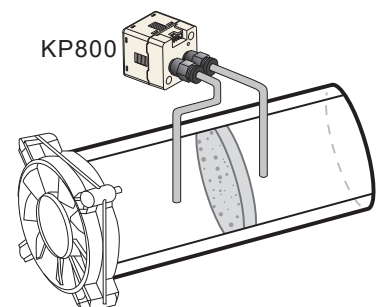

Specifications

MODEL	KP801	KP811	KP802	KP812	KP805	KP815
Rated Pressure Range	0 ~ 1000 Pa	-1000 ~ 1000 Pa	0.00 ~ 2.00 kPa	-2.00 ~ 2.00 kPa	0.0 ~ 5.00 kPa	-5.00 ~ 5.00 kPa
Setting Pressure Range	-100 ~ 1000 Pa	-1000 ~ 1000 Pa	-0.20 ~ 2.00 kPa	-2.00 ~ 2.00 kPa	-0.50 ~ 5.00 kPa	-5.00 ~ 5.00 kPa
Withstand Pressure	3 kPa		6 kPa		15 kPa	
Fluid	Filtered air, Non-corrosive / Non-flammable gas					
Set Pressure	Pa	1		-		
Resolution	kPa	-		0.01		
Power Supply Voltage	12 to 24 V DC $\pm 10\%$, Ripple (P-P) 10 % or less					
Current Consumption	≤ 40 mA (With no load)					
Switch Output	2NPN : open collector 2 outputs Max. Load Current : 125 mA Max. Supply Voltage : 30 V DC Residual Voltage : ≤ 1.5 V			2PNP : open collector 2 outputs Max. Load Current : 125 mA Max. Supply Voltage : 24 V DC Residual Voltage : ≤ 1.5 V		
Repeatability (Switch Output)	$\pm 0.5\%$ F.S. ± 1 digit					
Hysteresis	Hysteresis mode	Adjustable				
	Window comparator mode					
Response Time	≤ 2.0 ms (chattering-proof function : 32 ms, 128 ms, 1024 ms selectable)					
Output Short Circuit Protection	Yes					
Display	3 ½ digital, 7 segment LCD display (White) (Sampling rate : 5 times / sec.)					
Indicator Accuracy	$\pm 2\%$ F.S. ± 1 digit (ambient temperature : 25 ± 3 °C)					
Switch on Indicator	White indicator 1 : OUT1 & White indicator 2 : OUT2					
Analog Output (Voltage Output) *1	Output Voltage : 1 to 5 V $\pm 2.5\%$ F.S. (within rated pressure range) Linearity : $\pm 1\%$ F.S. Output impedance : about 1 k Ω					
Analog output (Current Output) *2	Output Current : 4 to 20 mA $\pm 2.5\%$ F.S. (within rated pressure range) Linearity : $\pm 1\%$ F.S. Max.Load impedance : 250 Ω at power supply of 12 V / 600 Ω at power supply of 24 V Min.Load impedance : 50 Ω					
Environment	Enclosure	IP 40				
	Ambient Temp. Range	Operation : 0 ~ 50 °C, Storage : -10 ~ 60 °C (No condensation or freezing)				
	Ambient Humidity Range	Operation / Storage : 35 ~ 85 % RH (No condensation)				
	Withstand Voltage	1000 V AC in 1-min (between case and lead wire)				
	Insulation Resistance	50 M Ω (at 500 V DC, between case and lead wire)				
	Vibration	Total amplitude 1.5 mm or 10 G, 10 Hz - 150 Hz - 10 Hz scan for 1 minute, two hours each direction of X, Y and Z				
	Shock	100 m/s ² (10 G), 3 times each in direction of X, Y and Z				
Temperature Characteristic	$\pm 3\%$ F.S. of detected pressure (25 °C) at temp. Range of 0 ~ 50 °C					
Port Size	M5					
Lead Wire	Oil-resistance cable (0.15 mm ²)					
Weight	Approx. 75 g (with 2 meter lead wire)					

NOTE :

*1 : If analog voltage output is selected, the analog current output cannot be selected at the same time.

*2 : If analog current output is selected, the analog voltage output cannot be selected at the same time.

KP800 SERIES

Differential Pressure Sensor

Panel Description

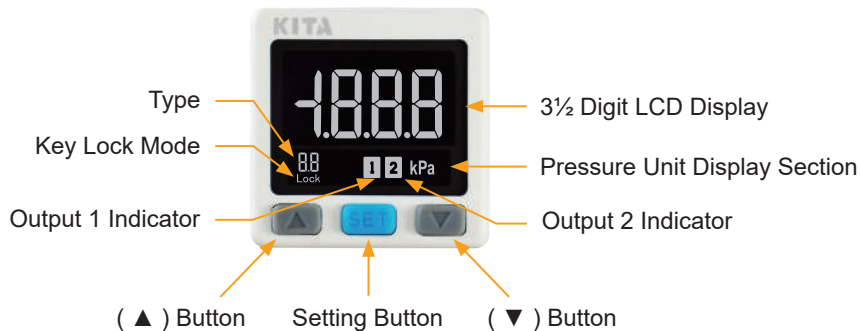

Installation Precautions

- When mounting, always use the wrench on the metallic area near the pressure port. Never apply a wrench to the plastic body, it will damage the sensor.
- Over tightening may cause damages to the port thread, mounting bracket and pressure sensor. Under tightening may result loosen or leakage.
- Apply pressure and power after installation and make necessary adjustments and inspect any possible signs of leakage to ensure proper installation.

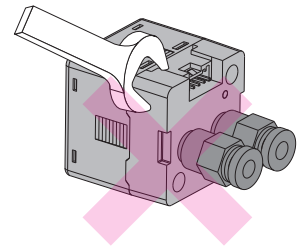
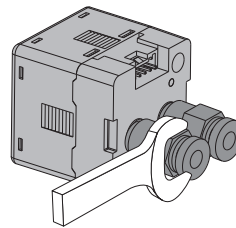

Output Circuit Wiring Diagrams

KP8□ - 010 - M5

2 NPN + Analog Output (1 ~ 5 V)

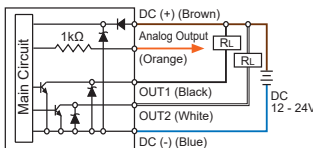

KP8□ - 030 - M5

2 PNP + Analog Output (1 ~ 5 V)

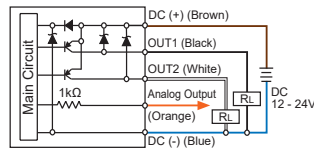

KP8□ - 011 - M5

2 NPN + Analog Output (4 ~ 20 mA)

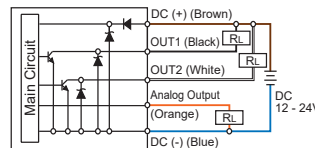

KP8□ - 031 - M5

2 PNP + Analog Output (4 ~ 20 mA)

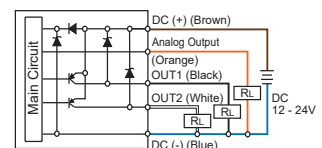

Ordering Information

K P 8 0 1 - 0 1 0 - M 5

Pressure Range

01 : (-100 ~ 1000 Pa) 11 : (-1000 ~ 1000 Pa)
 02 : (-0.20 ~ 2.00 kPa) 12 : (-2.00 ~ 2.00 kPa)
 05 : (-0.50 ~ 5.00 kPa) 15 : (-5.00 ~ 5.00 kPa)

Output Specifications

010 : 2 NPN output + Analog output (1 ~ 5 V)
 011 : 2 NPN output + Analog output (4 ~ 20 mA)
 030 : 2 PNP output + Analog output (1 ~ 5 V)
 031 : 2 PNP output + Analog output (4 ~ 20 mA)

Optional Parts

BT-20 : Mounting bracket
 BT-21 : Mounting bracket
 PA-C : Panel adapter
 PA-D : Panel adapter + Front protective lid

Optional Parts

- Mounting Bracket : BT-20 / BT-21

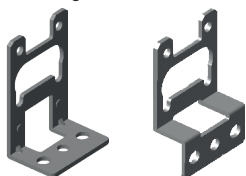

- Panel Adapter : PA-C



- Panel Adapter + Front Protective Lid : PA-D



Dimensions

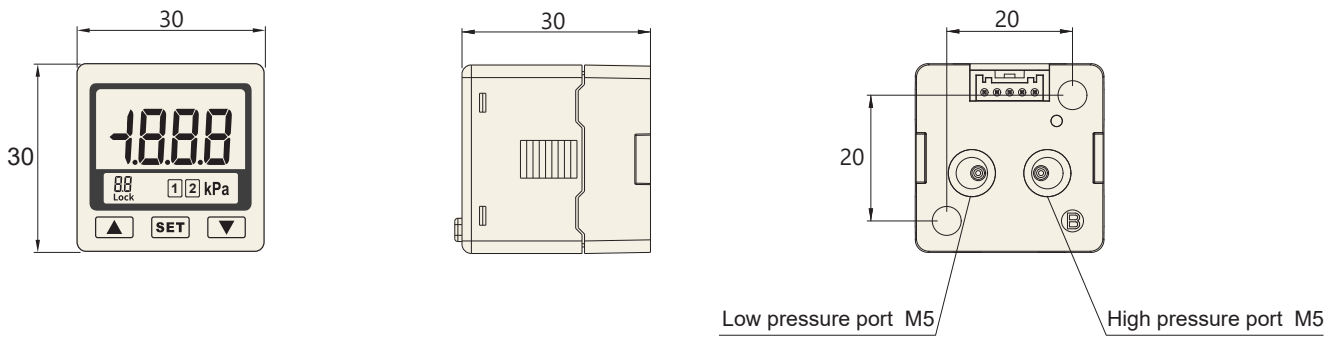

Optional Parts Dimensions

1 Mounting Bracket

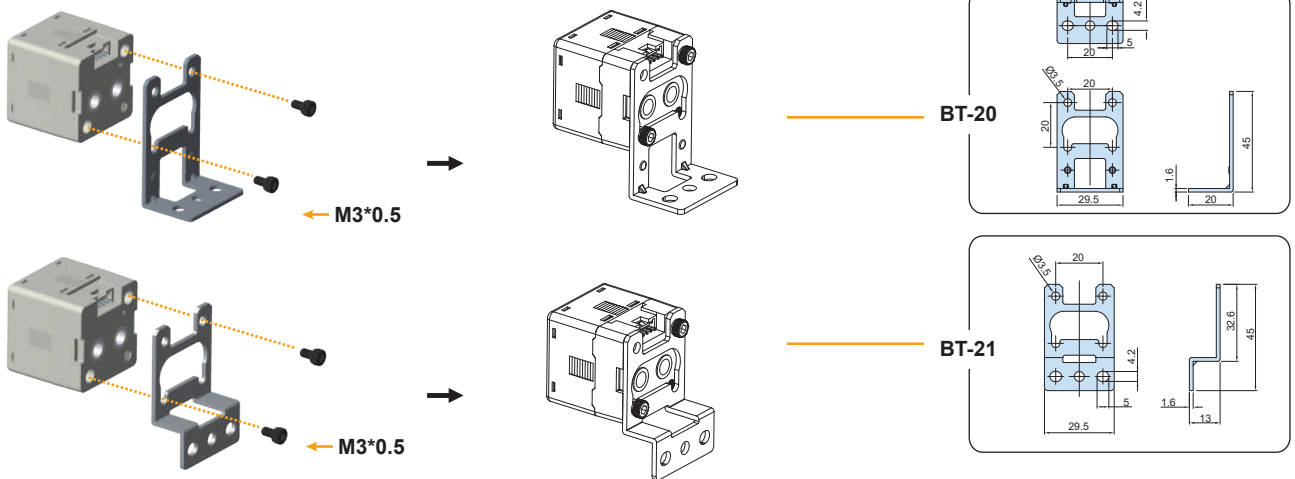

2 Panel Mount Adapter + Front Protective Lid

