

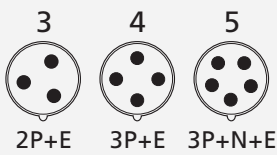

赛普 CEE/IEC 国际标准 明装插座

CEE/IEC INTERNATIONAL STANDARD SURFACE MOUNTED SOCKET

符合欧洲/国际标准 EN/IEC 60309-2
Conform to European / international standards EN/IEC 60309-2

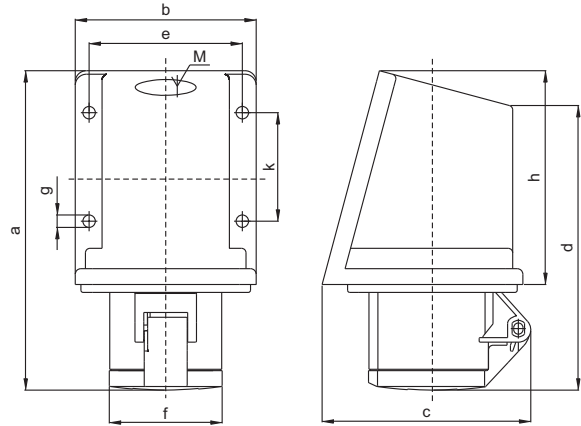

电流 极数
Current Poles

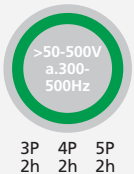
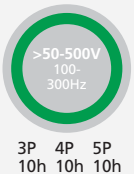
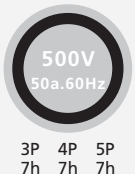
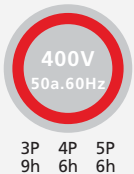
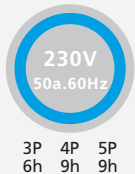
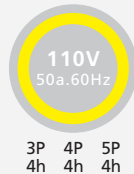

IP44 CEE/IEC 明装插座 Surface Mounted Socket 16A-32A

型号 MODEL	16	3	4	5	3P	4P	5P	3P	4P	5P	3P	4P	5P	3P	4P	5P		
		AP-100	AP-103	AP-109	AP-1420	AP-1423	AP-1555	AP-101	AP-104	AP-110	AP-1421	AP-1424	AP-1556	AP-102	AP-105	AP-111	AP-2000	AP-2169
	32	3	4	5	3P	4P	5P	3P	4P	5P	3P	4P	5P	3P	4P	5P	AP-2188	AP-2199
		3	4	5	3P	4P	5P	3P	4P	5P	3P	4P	5P	3P	4P	5P	AP-3139	AP-3134
		3	4	5	3P	4P	5P	3P	4P	5P	3P	4P	5P	3P	4P	5P	AP-3154	AP-3149

参数Parameter

尺寸:毫米 Size:mm

安培 Amp	16			安培 Amp	16			安培 Amp	32			安培 Amp	32		
极数 Poles	3	4	5	极数 Poles	3	4	5	极数 Poles	3	4	5	极数 Poles	3	4	5
a	141.2	141.2	141.2	k	49.7	49.7	49.7	a	152.3	152.3	157.3	k	49.7	49.7	49.7
b	80	80	80	M	25	25	25	b	80	80	80	M	25	25	25
c	92.2	94.2	95.3	导线横截面积(平方毫米)从最小至最大 Conductor crosssectional area (mm ²)Min. To Max			c	98.7	98.7	106.7	导线横截面积(平方毫米)从最小至最大 Conductor crosssectional area (mm ²)Min. To Max				
d	126	126	126	1.5~2.5			d	137	137	142	4-6				
e	67.7	67.7	67.7	1.5~2.5			e	67.7	67.7	67.7	4-6				
f	50	56	63	1.5~2.5			f	65.4	65.4	71.5	4-6				
g	5.5	5.5	5.5	1.5~2.5			g	5.5	5.5	5.5	4-6				
h	94.5	94.5	94.5	1.5~2.5			h	94.5	94.5	94.5	4-6				