



赛普 CEE/IEC 国际标准 暗装斜插座

CEE/IEC INTERNATIONAL STANDARD PANEL MOUNTED ANGLE SOCKET

符合欧洲/国际标准 EN/IEC 60309-2

Conform to European / international standards EN/IEC 60309-2

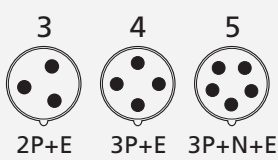
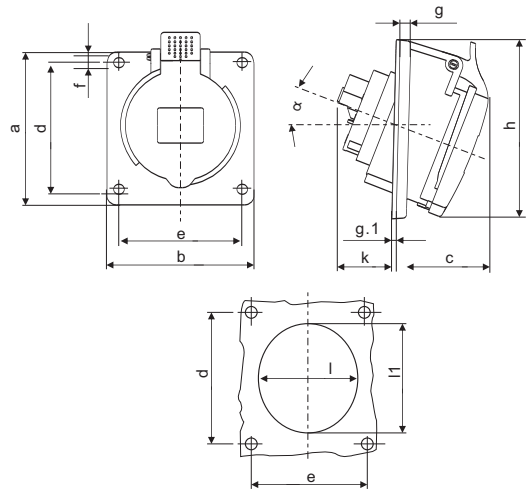

电流 极数
Current Poles

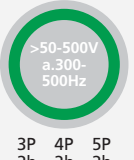
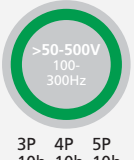
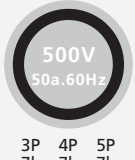
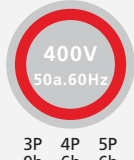
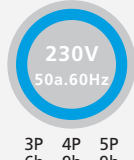
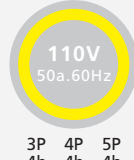

IP44 法兰尺寸 Flange Size 73.5 × 64 mm(16A,3P) , 100 × 92mm (16A,4P/5P、32A), 暗装插座 Panel Mounted Socket

| 型号 MODEL | 法兰尺寸 Flange Size | 16 | | 32 | | 32 | | 63 | | 63 | | |
|-------------|---------------------|-------------|-------------|---------------|---------------|-------------|-------------|-------------|-------------|-------------|-------------|--------|
| | | 极数 Poles | 型号 MODEL | 极数 Poles | 型号 MODEL | 极数 Poles | 型号 MODEL | 极数 Poles | 型号 MODEL | 极数 Poles | 型号 MODEL | |
| 16 | 73.5 × 64 | 3 | SP1462 | SP1463 | SP1464 | SP3186 | SP3187 | 3 | SP1462 | SP1463 | SP1464 | |
| | | 4 | SP1465 | SP1466 | SP1467 | SP1468 | SP1469 | SP1470 | 4 | SP1465 | SP1466 | SP1467 |
| | | 5 | SP1471 | SP1472 | SP1473 | SP1474 | SP1475 | SP1476 | 5 | SP1471 | SP1472 | SP1473 |
| | 100 × 92 | 3 | SP1491 | SP1492 | SP1493 | SP3201 | SP3202 | 3 | SP1491 | SP1492 | SP1493 | |
| | | 4 | SP1494 | SP1495 | SP1496 | SP1497 | SP1486 | SP1487 | 4 | SP1494 | SP1495 | SP1496 |
| | | 5 | SP1498 | SP1499 | SP1500 | SP1499 | SP3191 | SP3192 | 5 | SP1498 | SP1499 | SP1500 |
| 63 | 100 × 92 | 3 | SP1146 | SP1147 | SP1148 | SP3193 | SP3194 | 3 | SP1146 | SP1147 | SP1148 | |
| | | 4 | SP1149 | SP1150 | SP1151 | SP1152 | SP1153 | 4 | SP1149 | SP1150 | SP1151 | |
| | | 5 | SP1153 | SP1154 | SP1155 | | | 5 | SP1153 | SP1154 | SP1155 | |

参数 Parameter

尺寸:毫米 Size:mm

| 安培 Amp | 16 | | | 安培 Amp | 16 | | | 安培 Amp | 32 | | | 安培 Amp | 32 | | | 安培 Amp | 63 | | | 安培 Amp | 63 | | |
|-------------|------|-----|-----|---|---------|-----|-----|-------------|-----|-----|---|-------------|-----|-----|-----|-------------|-----|---|-----|-------------|-------|-----|-------|
| 极数 Poles | 3 | 4 | 5 | 极数 Poles | 3 | 4 | 5 | 极数 Poles | 3 | 4 | 5 | 极数 Poles | 3 | 4 | 5 | 极数 Poles | 3 | 4 | 5 | 极数 Poles | 3 | 4 | 5 |
| a | 73.5 | 100 | 100 | k | 41 | 41 | 41 | a | 100 | 100 | 100 | k | 51 | 51 | 52 | a | 110 | 110 | 110 | k | 69 | 69 | 69 |
| b | 64 | 92 | 92 | l | 55 | 70 | 70 | b | 92 | 92 | 92 | l | 73 | 73 | 75 | b | 106 | 106 | 106 | l | 91 | 91 | 91 |
| c | 52 | 58 | 58 | l1 | 65 | 80 | 80 | c | 62 | 62 | 62 | l1 | 85 | 85 | 86 | c | 85 | 85 | 85 | l1 | 102 | 102 | 102 |
| d | 60 | 85 | 85 | α | 20° | 20° | 20° | d | 85 | 85 | 85 | α | 20° | 20° | 20° | d | 85 | 85 | 85 | α | 20° | 20° | 20° |
| e | 52 | 77 | 77 | 导线横截面积(平方毫米) 从最小至最大 Conductor crosssectional area (mm²)Min. To Max | | | e | 77 | 77 | 77 | 导线横截面积(平方毫米) 从最小至最大 Conductor crosssectional area (mm²)Min. To Max | | | e | 77 | 77 | 77 | 导线横截面积(平方毫米) 从最小至最大 Conductor crosssectional area (mm²)Min. To Max | | | | | |
| f | 5.3 | 5.3 | 5.3 | f | 5.3 | 5.3 | 5.3 | f | 5.3 | 5.3 | 5.3 | f | 6.2 | 6.2 | 6.2 | f | 6.2 | 6.2 | 6.2 | f | 6.2 | 6.2 | 6.2 |
| g | 7 | 8 | 8 | g | 1.5-2.5 | g | 8 | 8 | 8 | g | 4-6 | g | 12 | 12 | 12 | g | 12 | 12 | 12 | g | 10-16 | g | 10-16 |
| g.1 | 2 | 2 | 2 | g.1 | 2 | 2 | 2 | g.1 | 2 | 2 | 2 | g.1 | 2 | 2 | 2 | g.1 | 2 | 2 | 2 | g.1 | 2 | 2 | 2 |
| h | 79 | 105 | 105 | h | 107 | 107 | 112 | h | 107 | 107 | 112 | h | 122 | 122 | 122 | h | 122 | 122 | 122 | h | 122 | 122 | 122 |